

# EQUINOXE range

## Interface datasheet

EQUINOXE Top single 1330

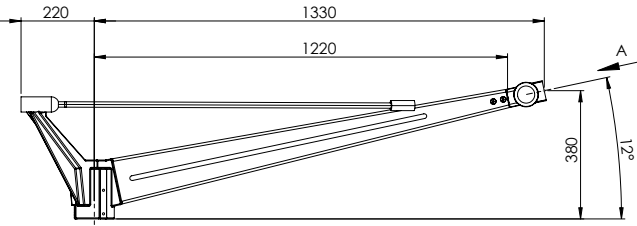

EQUINOXE Top double 1220

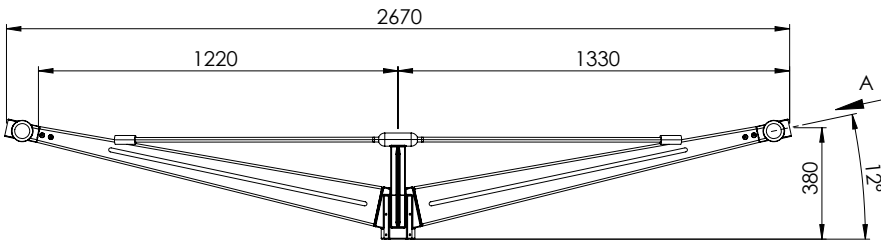

EQUINOXE Top single 1720

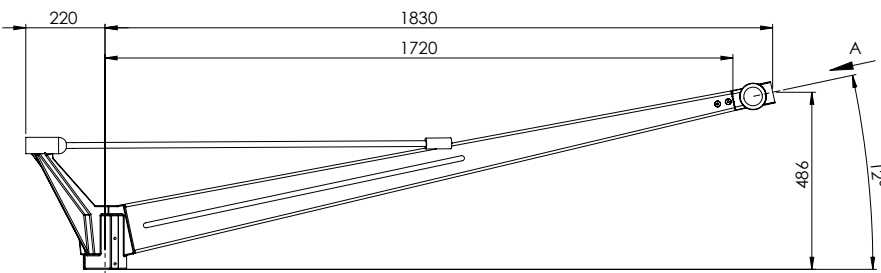

EQUINOXE Top single 2595

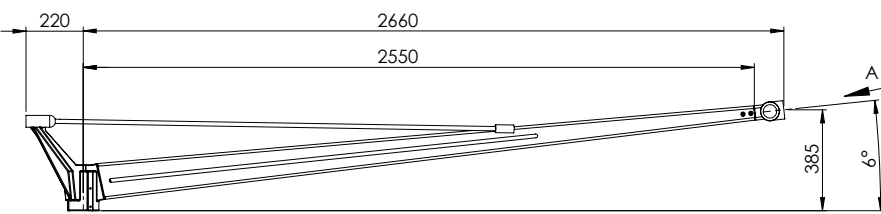

EQUINOXE wall 1388

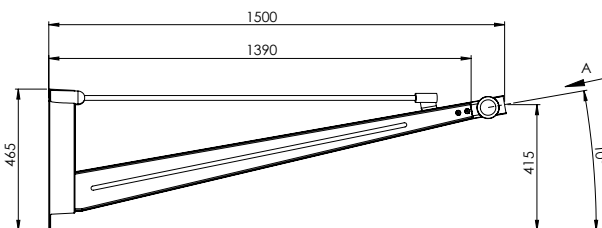

EQUINOXE annular on pole EP4

VARIANT	Ø1	Pole diameter installation
EP4 130	180	125 < Ø installation < 130
EP4 142	192	137 < Ø installation < 142
EP4 160	208	155 < Ø installation < 160

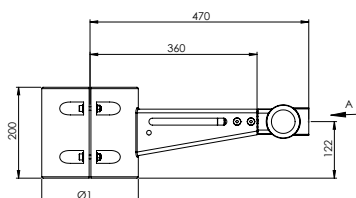

EQUINOXE wall EP4

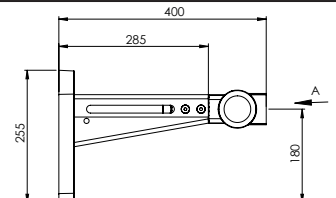

Pole post top interface

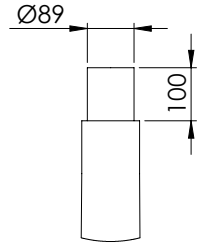

View A (from the luminaire) for all EQUINOXE range

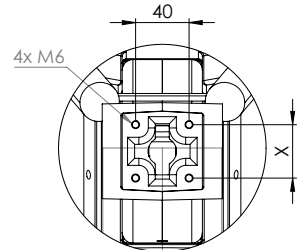

VIEW A  
(View from the luminaire)

Variant	X
Equinoxe PR (CMS mini / Midi)	40
Equinoxe GR (CMS Maxi)	49